

MANIPOLAZIONE DEL RESPIRABILE (14): Engage or disengage depending on whether or not you intend to proceed in mode inverse for remounting the respirator.

RUSS A ПАНОВИНА B БИДЕ

К1. Установить мановентиль (14), engage или disengage depending on whether or not you intend to proceed in mode inverse for remounting the respirator.

LAVABO B BIDET

Mount the basin (1) and bowl (11), and connect the water supply hoses; mount the flexible drain (2); insert the drain (2) into the basin (1) and connect the water supply hoses; insert the drain (2) into the basin (1) and connect the water supply hoses; insert the drain (2) into the basin (1) and connect the water supply hoses.

WASH BASIN B BIDET

Fit the supply pipes (1) by tightening it using the proper wrench; fit the water supply hoses (2); insert the drain (2) into the basin (1) and connect the water supply hoses; insert the drain (2) into the basin (1) and connect the water supply hoses; insert the drain (2) into the basin (1) and connect the water supply hoses.

WASCHBECKEN B BIDET

Die Verteilung des Wasserdruckes (14) einstellen; die Impulshilfe deaktivieren oder aktivieren; die Impulshilfe aktivieren; die Impulshilfe deaktivieren oder aktivieren; die Impulshilfe aktivieren; die Impulshilfe deaktivieren oder aktivieren; die Impulshilfe aktivieren; die Impulshilfe deaktivieren oder aktivieren.

LAVABO B BIDET

Mount the basin (1) and bowl (11), and connect the water supply hoses; mount the flexible drain (2); insert the drain (2) into the basin (1) and connect the water supply hoses; insert the drain (2) into the basin (1) and connect the water supply hoses; insert the drain (2) into the basin (1) and connect the water supply hoses.

ПАНОВИНА B БИДЕ

Установить мановентиль (14), engage или disengage depending on whether or not you intend to proceed in mode inverse for remounting the respirator.

WASH BASIN B BIDET

Fit the supply pipes (1) by tightening it using the proper wrench; fit the water supply hoses (2); insert the drain (2) into the basin (1) and connect the water supply hoses; insert the drain (2) into the basin (1) and connect the water supply hoses; insert the drain (2) into the basin (1) and connect the water supply hoses.

LAVABO B BIDET

Mount the basin (1) and bowl (11), and connect the water supply hoses; mount the flexible drain (2); insert the drain (2) into the basin (1) and connect the water supply hoses; insert the drain (2) into the basin (1) and connect the water supply hoses; insert the drain (2) into the basin (1) and connect the water supply hoses.

WASH BASIN B BIDET

Fit the supply pipes (1) by tightening it using the proper wrench; fit the water supply hoses (2); insert the drain (2) into the basin (1) and connect the water supply hoses; insert the drain (2) into the basin (1) and connect the water supply hoses; insert the drain (2) into the basin (1) and connect the water supply hoses.

WASCHBECKEN B BIDET

Die Verteilung des Wasserdruckes (14) einstellen; die Impulshilfe deaktivieren oder aktivieren; die Impulshilfe aktivieren; die Impulshilfe deaktivieren oder aktivieren; die Impulshilfe aktivieren; die Impulshilfe deaktivieren oder aktivieren; die Impulshilfe aktivieren; die Impulshilfe deaktivieren oder aktivieren.

LAVABO B BIDET

Mount the basin (1) and bowl (11), and connect the water supply hoses; mount the flexible drain (2); insert the drain (2) into the basin (1) and connect the water supply hoses; insert the drain (2) into the basin (1) and connect the water supply hoses; insert the drain (2) into the basin (1) and connect the water supply hoses.

ПАНОВИНА B БИДЕ

Установить мановентиль (14), engage или disengage depending on whether or not you intend to proceed in mode inverse for remounting the respirator.

WASH BASIN B BIDET

Fit the supply pipes (1) by tightening it using the proper wrench; fit the water supply hoses (2); insert the drain (2) into the basin (1) and connect the water supply hoses; insert the drain (2) into the basin (1) and connect the water supply hoses; insert the drain (2) into the basin (1) and connect the water supply hoses.

WASCHBECKEN B BIDET

Die Verteilung des Wasserdruckes (14) einstellen; die Impulshilfe deaktivieren oder aktivieren; die Impulshilfe aktivieren; die Impulshilfe deaktivieren oder aktivieren; die Impulshilfe aktivieren; die Impulshilfe deaktivieren oder aktivieren; die Impulshilfe aktivieren; die Impulshilfe deaktivieren oder aktivieren.

DACCIA ESTERNO

Diagono un installato gli accessori (1), verificare la planarità e la distanza tra il piano di coperta (2) e il muro (3); montare la guarnizione (3) e fissare il gruppo agli accessori tramite la cavità (4).

EXPOSED SHOWER

After installing the eccentric thread fittings (1), check planarity and checking that the distance between centres is equal to 150 mm; fit the wall trim (2); insert the gasket (3) and fix the group onto the eccentric thread fittings using the covers (4).

DUSCHE IM AUßENBEREICH

Diagono un installato gli accessori (1), verificare la planarità e la distanza tra il piano di coperta (2) e il muro (3); montare la guarnizione (3) e fissare il gruppo agli accessori tramite la cavità (4).

DOUCHE EXTERIEURE

Après avoir installé les raccords excentrés (1), vérifier la planéité et que l'écart entre les deux centres soit égal à 150 mm; monter les rebords de finition (2); insérer la garniture (3) et fixer le groupe sur les raccords excentrés à l'aide des couvercles (4).

DUCHA EXTERIOR

Tras haber instalado los accesorios (1), verificar la planaridad y la distancia entre ejes (150 mm); montar los forros decorativos (2); introducir la junta (3) y fijar el grupo sobre los accesorios excentrados (4).

DUCHA INTERNA

Diagono un installato gli accessori (1), verificare la planarità e la distanza tra il piano di coperta (2) e il muro (3); montare la guarnizione (3) e fissare il gruppo agli accessori tramite la cavità (4).

НАРУЖНЫЙ ДУШ

После установки элементов (1) проверить правильность расположения и свернуть расстояние между ними - 150 мм, установить накладку (2) и закрепить уплотнитель (3) и закрыть крышку (4).

WASCHBECKEN B BIDET

Die Verteilung des Wasserdruckes (14) einstellen; die Impulshilfe deaktivieren oder aktivieren; die Impulshilfe aktivieren; die Impulshilfe deaktivieren oder aktivieren; die Impulshilfe aktivieren; die Impulshilfe deaktivieren oder aktivieren; die Impulshilfe aktivieren; die Impulshilfe deaktivieren oder aktivieren.



VASCA - DACCIA

Diagono un installato gli accessori (1), verificare la planarità e la distanza tra il piano di coperta (2) e il muro (3); montare la guarnizione (3) e fissare il gruppo agli accessori tramite la cavità (4).

BATHUB - SHOWER

After installing the eccentric thread fittings (1), check planarity and checking that the distance between centres is equal to 150 mm; fit the wall trim (2); insert the gasket (3) and fix the group onto the eccentric thread fittings using the covers (4).

BADEWANNE - DUSCHE

Nach dem Einbau aller Bauteile (1) die Ebenheit und den Abstand von 150 mm überprüfen und die Abdeckkappe (2) montieren; die Dichtung (3) einsetzen und die Dichtung über die Abdeckkappe (4) drücken.

BAÑERA - DUCHA

Tras haber instalado los accesorios (1), verificar la planaridad y la distancia entre ejes (150 mm); montar los forros decorativos (2); introducir la junta (3) y fijar el grupo sobre los accesorios excentrados (4).

BANHEIRA - DUCHA

Depois de ter instalado os acessórios (1), verificar se estão planos e a distância entre os eixos é de 150 mm; montar as tampas decorativas (2); inserir a junta (3) e fixar o grupo nos acessórios excêntricos através da cavidade (4).

ВАННА - ДУШ

После установки элементов (1) проверить правильность расположения и свернуть расстояние между ними - 150 мм, установить накладку (2) и закрепить уплотнитель (3) и закрыть крышку (4).

WASCHBECKEN B BIDET

Die Verteilung des Wasserdruckes (14) einstellen; die Impulshilfe deaktivieren oder aktivieren; die Impulshilfe aktivieren; die Impulshilfe deaktivieren oder aktivieren; die Impulshilfe aktivieren; die Impulshilfe deaktivieren oder aktivieren; die Impulshilfe aktivieren; die Impulshilfe deaktivieren oder aktivieren.



LAVABO

Install the basin (1) and bowl (11) and connect the water supply hoses; insert the drain (2) into the basin (1) and connect the water supply hoses; insert the drain (2) into the basin (1) and connect the water supply hoses; insert the drain (2) into the basin (1) and connect the water supply hoses.

WASH BASIN

Install the conical bowl (1) and connect the two water inlets; screw on the spout (2); slide the wall trim (3) and insert the drain (4) in the middle; on the cap (3) and on the spout (2) - only tight against the wall face. Fit the two handles (6), laying them on the handles (5) and fitting through the grab screw (7).

WASCHBECKEN

Die Verteilung des Wasserdruckes (14) einstellen; die Impulshilfe deaktivieren oder aktivieren; die Impulshilfe aktivieren; die Impulshilfe deaktivieren oder aktivieren; die Impulshilfe aktivieren; die Impulshilfe deaktivieren oder aktivieren; die Impulshilfe aktivieren; die Impulshilfe deaktivieren oder aktivieren.

LAVABO

Install the basin (1) and bowl (11) and connect the water supply hoses; insert the drain (2) into the basin (1) and connect the water supply hoses; insert the drain (2) into the basin (1) and connect the water supply hoses; insert the drain (2) into the basin (1) and connect the water supply hoses.

WASH BASIN

Install the conical bowl (1) and connect the two water inlets; screw on the spout (2); slide the wall trim (3) and insert the drain (4) in the middle; on the cap (3) and on the spout (2) - only tight against the wall face. Fit the two handles (6), laying them on the handles (5) and fitting through the grab screw (7).

WASCHBECKEN

Die Verteilung des Wasserdruckes (14) einstellen; die Impulshilfe deaktivieren oder aktivieren; die Impulshilfe aktivieren; die Impulshilfe deaktivieren oder aktivieren; die Impulshilfe aktivieren; die Impulshilfe deaktivieren oder aktivieren; die Impulshilfe aktivieren; die Impulshilfe deaktivieren oder aktivieren.

LAVABO

Install the basin (1) and bowl (11) and connect the water supply hoses; insert the drain (2) into the basin (1) and connect the water supply hoses; insert the drain (2) into the basin (1) and connect the water supply hoses; insert the drain (2) into the basin (1) and connect the water supply hoses.

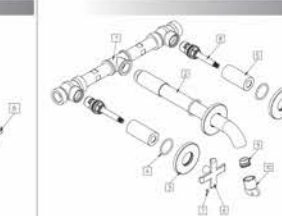

LAVABO

Install the basin (1) and bowl (11) and connect the water supply hoses; insert the drain (2) into the basin (1) and connect the water supply hoses; insert the drain (2) into the basin (1) and connect the water supply hoses; insert the drain (2) into the basin (1) and connect the water supply hoses.

WASH BASIN

Install the conical bowl (1) and connect the two water inlets; screw on the spout (2); slide the wall trim (3) and insert the drain (4) in the middle; on the cap (3) and on the spout (2) - only tight against the wall face. Fit the two handles (6), laying them on the handles (5) and fitting through the grab screw (7).

WASCHBECKEN

Die Verteilung des Wasserdruckes (14) einstellen; die Impulshilfe deaktivieren oder aktivieren; die Impulshilfe aktivieren; die Impulshilfe deaktivieren oder aktivieren; die Impulshilfe aktivieren; die Impulshilfe deaktivieren oder aktivieren; die Impulshilfe aktivieren; die Impulshilfe deaktivieren oder aktivieren.

LAVABO

Install the basin (1) and bowl (11) and connect the water supply hoses; insert the drain (2) into the basin (1) and connect the water supply hoses; insert the drain (2) into the basin (1) and connect the water supply hoses; insert the drain (2) into the basin (1) and connect the water supply hoses.

WASH BASIN

Install the conical bowl (1) and connect the two water inlets; screw on the spout (2); slide the wall trim (3) and insert the drain (4) in the middle; on the cap (3) and on the spout (2) - only tight against the wall face. Fit the two handles (6), laying them on the handles (5) and fitting through the grab screw (7).

WASCHBECKEN

Die Verteilung des Wasserdruckes (14) einstellen; die Impulshilfe deaktivieren oder aktivieren; die Impulshilfe aktivieren; die Impulshilfe deaktivieren oder aktivieren; die Impulshilfe aktivieren; die Impulshilfe deaktivieren oder aktivieren; die Impulshilfe aktivieren; die Impulshilfe deaktivieren oder aktivieren.

LAVABO

Install the basin (1) and bowl (11) and connect the water supply hoses; insert the drain (2) into the basin (1) and connect the water supply hoses; insert the drain (2) into the basin (1) and connect the water supply hoses; insert the drain (2) into the basin (1) and connect the water supply hoses.